

ET16

Tracked Conventional Tail Excavators



**WACKER
NEUSON**
all it takes!



Best in class in terms of cabin size

In addition to its comfortable cabin, the ET16 also impresses with a compact and sturdy design. With a shipping weight of less than 1.6 tons, it can be quickly and easily transported from one construction site to the next. It is the ideal companion for any application due to a simple and safe operation.

- Full power for faster work cycles
- Comfort cabin for the highest demands
- Easy transportation
- Telescoping travel gear and powerful additional hydraulics
- Unrestricted service and maintenance access

ET16 Technical specifications

Operating data

| | |
|------------------------------|------------------------|
| Shipping weight min. | 1,402 kg |
| Operating weight | 1,529 - 1,720 kg |
| Biting force max. | 7.9 kN |
| Breakout force max. | 15.3 kN |
| Digging depth max. | 2,413 mm |
| Dumping height | 2,371 - 2,518 mm |
| Digging radius max. | 3,861 mm |
| Superstructure slewing speed | 9.8 1/min |
| L x W x H | 3,644 x 990 x 2,285 mm |

Engine / Motor

| | |
|-------------------------------------|---|
| Engine / Motor manufacturer | Yanmar |
| Engine / Motor type | 3TNV76 |
| Engine / Motor | Liquid-cooled, 3-cylinder diesel engine |
| Emission standards stage | 5 |
| Displacement | 1,116 cm ³ |
| RPM / speed | 2,200 rpm |
| Engine performance according to ISO | 13.8 kW |
| Battery | 44 Ah |
| Fuel tank capacity | 24 l |

Hydraulic system

| | |
|---|------------|
| Duty pump | Gear pump |
| Flow rate | 34.5 l/min |
| Operating pressure for working and driving hydraulics | 200 bar |
| Operating pressure slewing gear | 130 bar |
| Hydraulic oil tank | 20 l |

Undercarriage

| | |
|------------------|----------|
| Travel speed | 4.1 km/h |
| Chain width | 230 mm |
| Ground clearance | 180 mm |

Dozer Blade

| | |
|----------------------------|--------|
| Width folded-over | 990 mm |
| Height | 215 mm |
| Stroke max. above subgrade | 235 mm |
| Stroke max. below subgrade | 270 mm |

Sound level

| | |
|--|----------|
| Sound level (LwA) according to 2000/14/EC | 93 dB(A) |
| Cabin - specified sound pressure level LpA | 79 dB(A) |

ET16 Dimensions

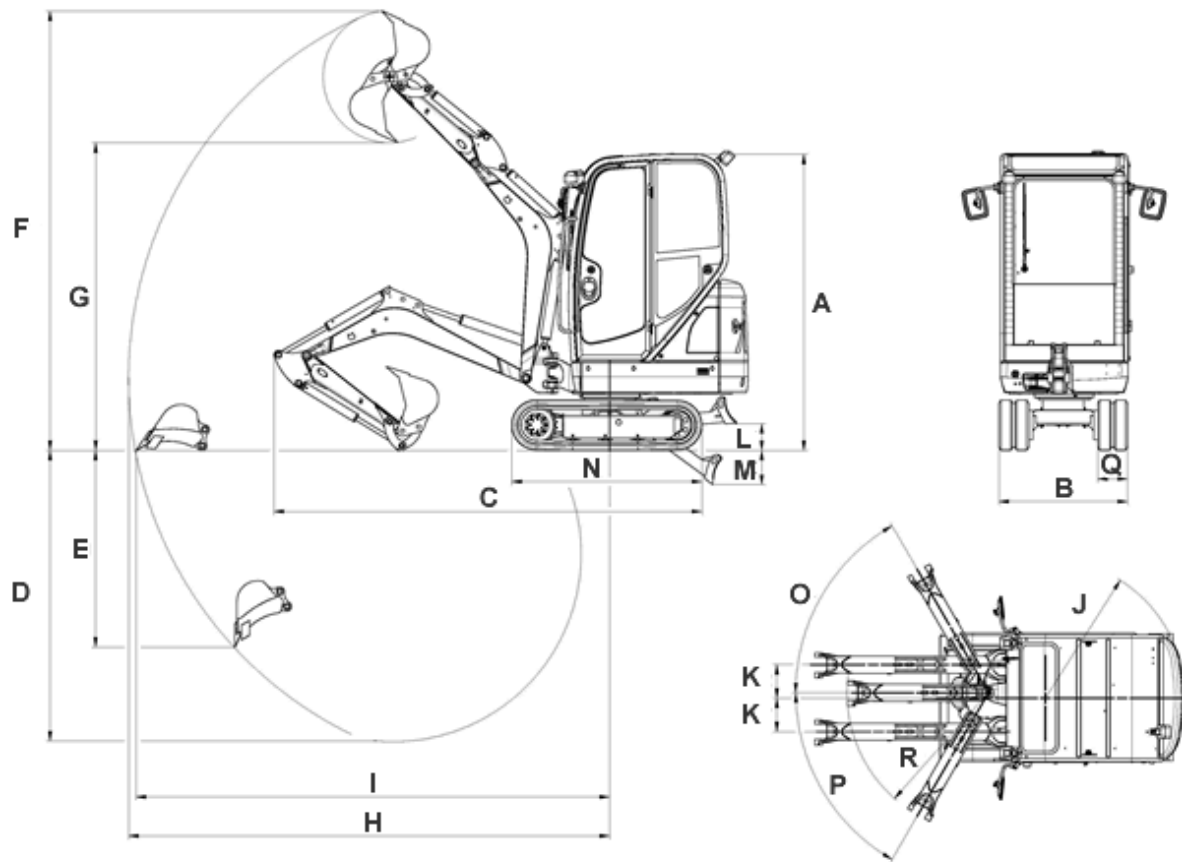

| | | Standard travel gear | Telescopic travel gear |
|---|--|----------------------|------------------------|
| A | Height | 2,285 mm | 2,317 mm |
| B | Width track | 990 mm | 990 mm |
| B | Width track extended | | 1,300 mm |
| C | Transport length short dipper stick | 3,644 mm | 3,648 mm |
| C | Transport length long dipper stick | 3,607 mm | 3,606 mm |
| D | Digging depth max. short dipper stick | 2,242 mm | 2,202 mm |
| D | Digging depth max. long dipper stick | 2,413 mm | 2,372 mm |
| E | Insertion depth short dipper stick | 1,642 mm | 1,605 mm |
| E | Insertion depth long dipper stick | 1,802 mm | 1,764 mm |
| F | Insertion height short dipper stick | 3,387 mm | 3,408 mm |
| F | Insertion height long dipper stick | 3,508 mm | 3,529 mm |
| G | Dump height max. short dipper stick | 2,371 mm | 2,396 mm |
| G | Dump height max. long dipper stick | 2,493 mm | 2,518 mm |
| H | Digging radius max. short dipper stick | 3,700 mm | 3,700 mm |
| H | Digging radius max. long dipper stick | 3,861 mm | 3,860 mm |
| I | Range short dipper stick | 3,648 mm | 3,642 mm |
| I | Range long dipper stick | 3,811 mm | 3,806 mm |
| J | Rear swivel radius | 1,075 mm | 1,075 mm |
| K | Arm displacement max. to center of bucket right side | 432 mm | 432 mm |

| | | | |
|---|---|----------|----------|
| K | Arm displacement max. to center of bucket left side | 287 mm | 287 mm |
| L | Lift height max. dozer blade above grade | 211 mm | 235 mm |
| M | Scraping depth max. dozer blade below grade | 264 mm | 270 mm |
| N | Length travel gear | 1,462 mm | 1,462 mm |
| O | Turning angle max. (boom system to the right) | 49 ° | 49 ° |
| P | Turning angle max. (boom system to the left) | 73 ° | 73 ° |
| Q | Chain width | 230 mm | 230 mm |
| R | Boom slewing radius | 1,195 mm | 1,195 mm |

Please note: that product availability can vary from country to country. It is possible that information / products may not be available in your country. More detailed information on engine power can be found in the operator's manual; the stated power may vary due to specific operating conditions. Subject to alterations and errors excepted. Applicable also to illustrations.

Copyright © 2022 Wacker Neuson SE.